

Basement Floor Plan
Ceiling Height = 7'-0"

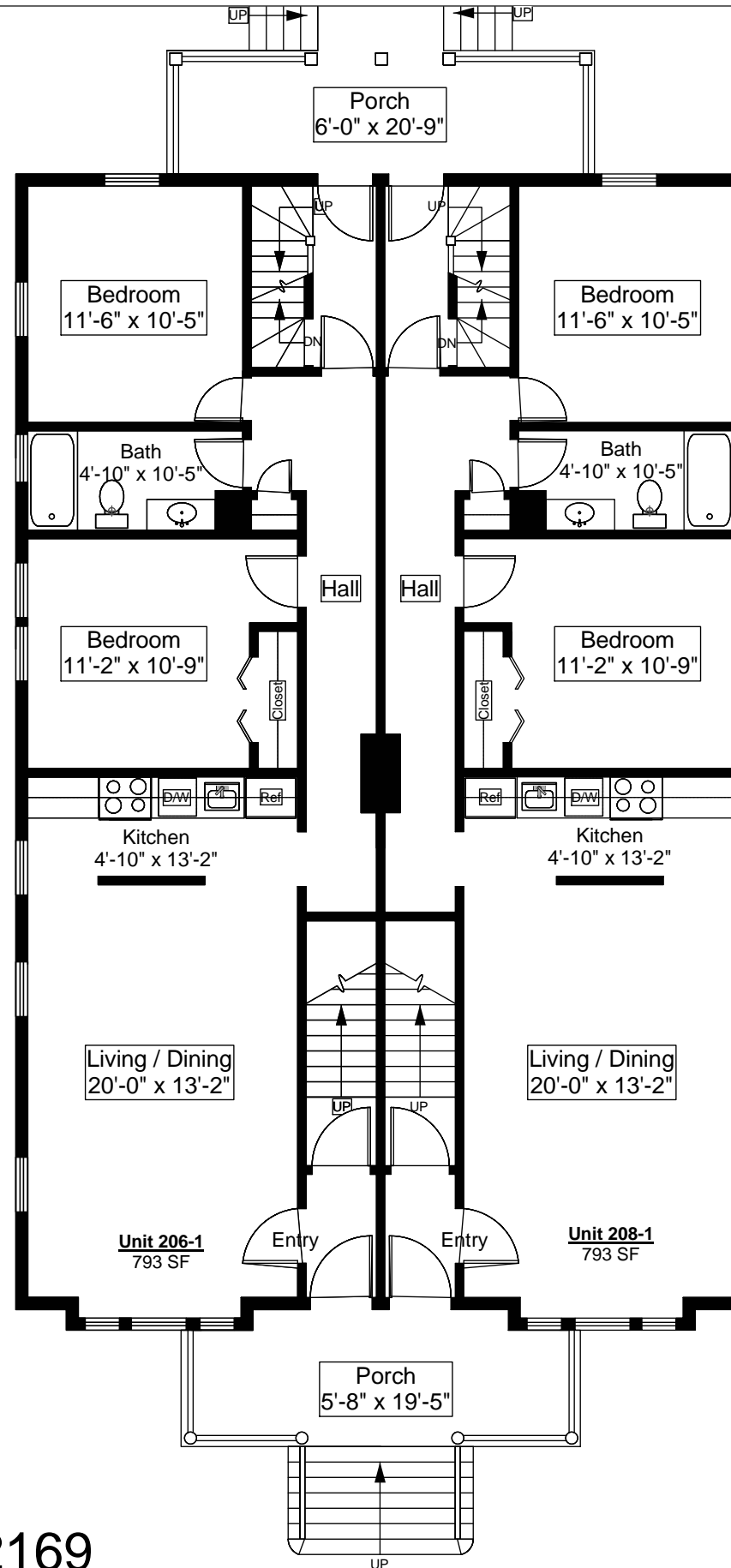

First Floor Plan
Ceiling Height = 8'-5"

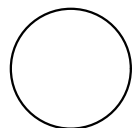

206 - 208 Federal Avenue, Quincy, MA 02169

SCALE: 1/8" = 1'-0"



the
**HOLLAND
COMPANIES**

Design & Construction

1126 Main Street
Weymouth, MA
02190

Phone 781.335.4275
Fax 781.340.0077

thehollandcompanies.com

Note - Dimensions are
not guaranteed and are
provided for informational
purposes only.

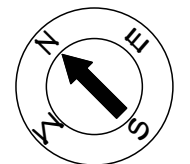

PRINT DATE:
August 2009

PROJECT NAME:
Rental Property

PROJECT ADDRESS:
206 - 208 Federal Avenue
Quincy, MA

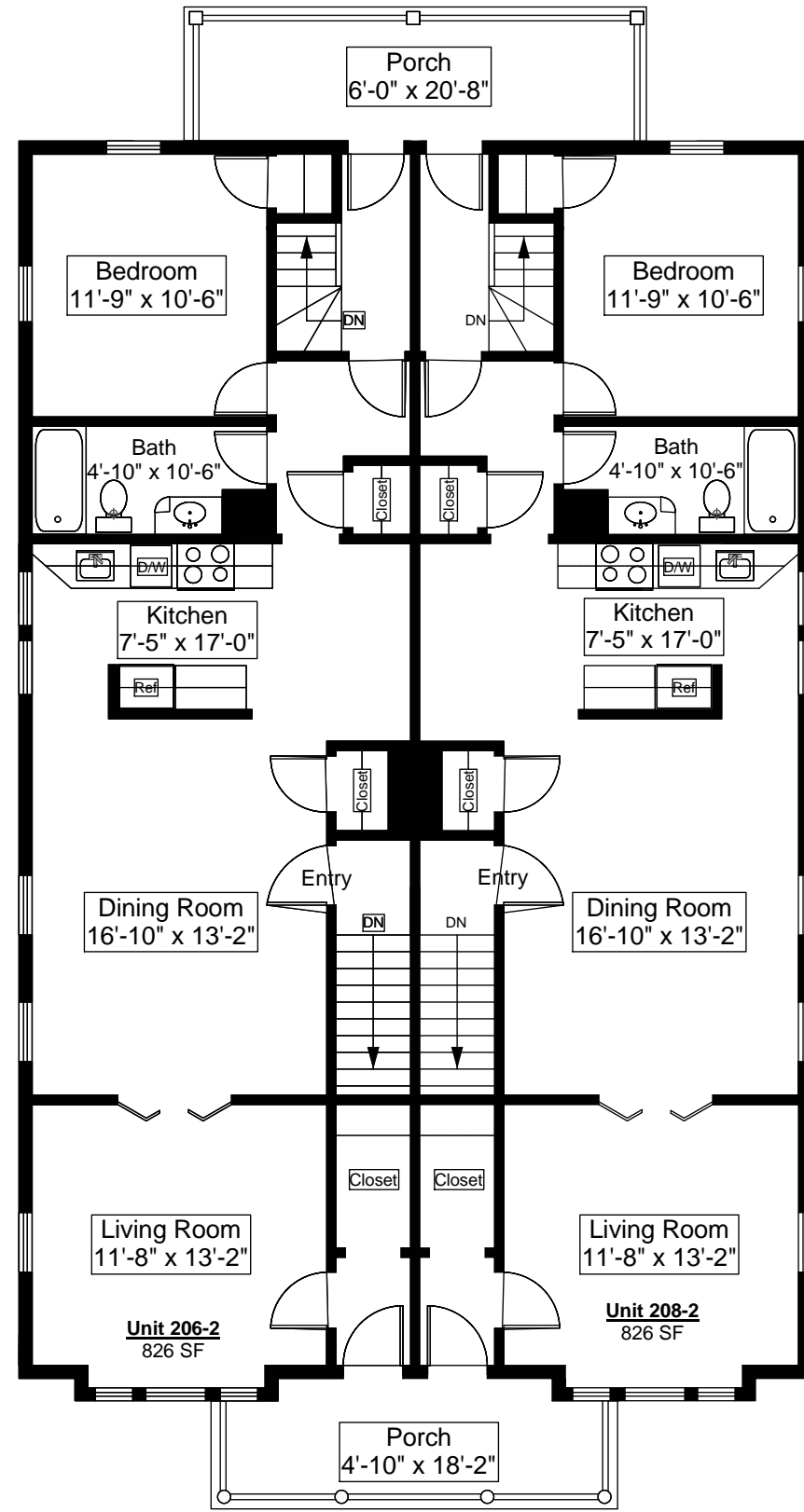

Second Floor Plan
Ceiling Height = 8'-5"

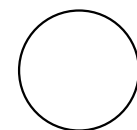

206 - 208 Federal Avenue, Quincy, MA 02169

SCALE: 1/8" = 1'-0"



the
**HOLLAND
COMPANIES**

Design & Construction

1126 Main Street
Weymouth, MA
02190

Phone 781.335.4275
Fax 781.340.0077

thehollandcompanies.com

Note - Dimensions are not guaranteed and are provided for informational purposes only.

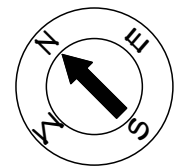

PRINT DATE:
August 2009

PROJECT NAME:
Rental Property

PROJECT ADDRESS:
206 - 208 Federal Avenue
Quincy, MA